

66253

Location of Wastewater Connection



Public Works Maintenance
1820 Roosevelt Blvd.
Eugene, Oregon 97402
(541) 682-4800

Property Information

Address 343 E. 15th Ave.
Map and Tax Lot _____ Owner ARD Community Property
Building Type: SFD Duplex Multi-Family Commercial Industrial

Permit Information

Permit No. 18-08045-01 Date of Issue 10-12-18
Contractor/Plumber Royal Flush Pipe Material Sch. 40 Pipe Diameter 4"
 Right of Way Cut Permit Required System Development Charge
Installation Date 10-26-18 Inspected By jim LaCasse
Permission granted to attach private sewer connection to public sewer in conformance to City standards and specifications.

Public Wastewater Information

Index Page No. 117a Segment No. 5571 5554 Contract No. _____
Upstream Downstream Inspected By _____

TWO WORKING DAYS BEFORE YOU DIG, CALL UTILITY ONE-CALL SERVICE AT 1-800-332-2344

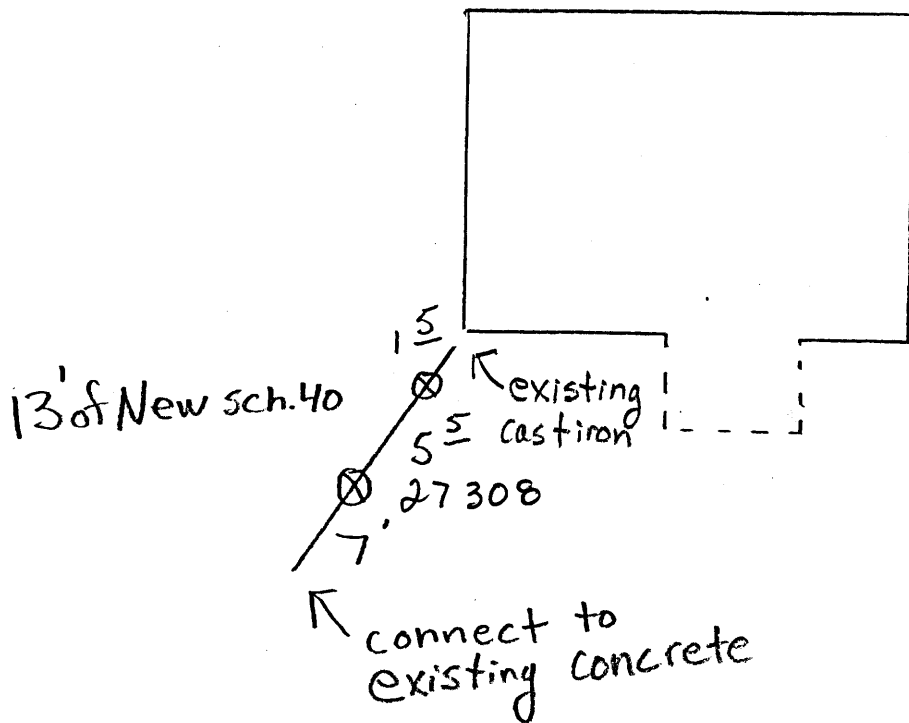

E. 15th